



100



# RIGOLE

## FLAT 100

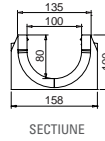
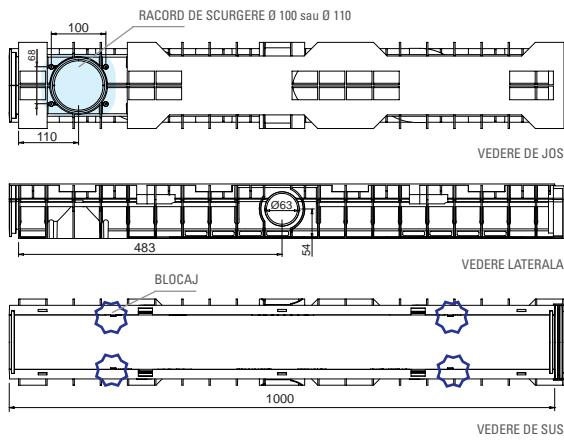

### FLAT 100/80

COD	PRET	MATERIAL	DIMENSIUNI EXTERNA L x l x h mm	DIMENSIUNI INTERNE L x l x h mm	GREUTATE kg	SECTIUNE DRENARE cm <sup>2</sup>	CAPACITATE dm <sup>3</sup>	EVACUARI PREINSTALATE mm
706000	€	PE-HD	1000 x 158 x 100	1000 x 100 x 80	1,60	69,28	6,92	lateral inferior*** 2 x Ø 63 1 x Ø 100; 1 x Ø 110

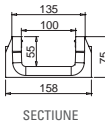
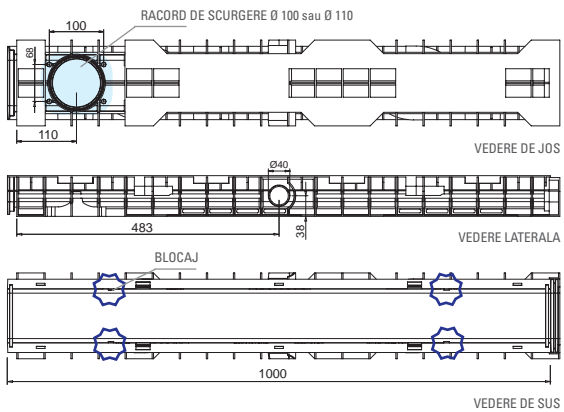

### FLAT 100/55

COD	PRET	MATERIAL	DIMENSIUNI EXTERNA L x l x h mm	DIMENSIUNI INTERNE L x l x h mm	GREUTATE kg	SECTIUNE DRENARE cm <sup>2</sup>	CAPACITATE dm <sup>3</sup>	EVACUARI PREINSTALATE mm
706001	€	PE-HD	1000 x 158 x 75	1000 x 100 x 55	1,40	54,44	5,44	lateral inferior*** 2 x Ø 40 1 x Ø 100; 1 x Ø 110

\*\*\* Pentru a obtine evacuarile dorite utilizati Kit Racorduri de evacuare (disponibile in doua versiuni Ø100 si Ø110).  
 § Etansare: pentru asigurarea unei etansari perfecte a rigolei, va sfatuim sa utilizati un adeziv de etansare bituminos.  
 Pentru informatii suplimentare contactati Departamentul Tehnic.  
 NOTA: Dimensiunile si greutatile se incadreaza in limite normale de toleranta.



# GRATARE



A 15

FLAT 100

## APLICATII ZINCAT

Zone verzi, parcuri  
Zone pietonale si/sau biciclisti  
Stadioane  
Teras

## APLICATII INOX INOX

Zone verzi, parcuri  
Zone pietonale si/sau biciclisti  
Stadioane  
Teras  
Bucatarii spitale, restaurante si similare

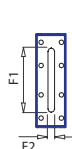

DETALIU FISURA

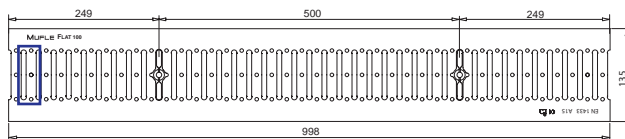

VEDERE DE SUS

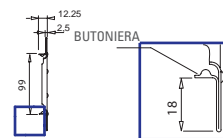

VEDERE LATERALA

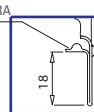

DETALIU INDOITURA

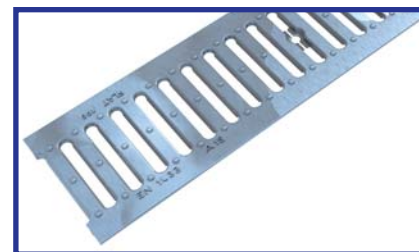

## GRATAR STANTAT



COD	PRET €	MATERIAL	DIMENSIUNI L x l x h mm	GREUTATE kg	SUPRAFATA DRENARE dm <sup>2</sup>	DESCHIDERE F1 x F2 mm	PRINDERE		
							bareta	clip	zimt (fara fixare)***
506110		otel DX51D** zincat	998 x 135 x 2,5	1,30	2,35	83,0 x 8,5			
506111		otel inox AISI 304* decatat							
506112		otel DX51D** zincat	498 x 135 x 2,5	0,65	1,175				
506113		otel inox AISI 304* decatat							

### MONTAJUL GRATARULUI PRIN CLIP

- asezati gratarul pe rigola astfel incat sa corespunda capul Clipului FLAT cu fantele prevazute pe gratar;
- apasati cu mana pe gratar pana cand se realizeaza imbinarea .

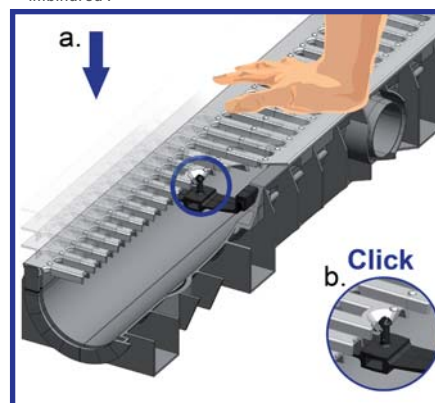

### DEMONTAREA GRATARULUI

- apasati usor pe capul sistemului Clip FLAT astfel incat sa scoateti gratarul din prindere;
- indepartati.

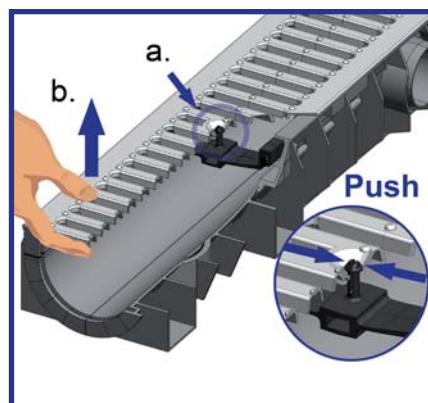

## NEW

Gratarul stantat FLAT poate fi fixat rapid si sigur utilizand noul sistem CLIP FLAT!!!

\* Clasificare conform normei americane ASTM.

\*\* Clasificare conform normei EN 10142 (ed.Luile 2002) si simbolistica conform normei EN 10027-1 (-2) (ed. septembrie 1993).

\*\*\* Sistem de blocare cu ajutorul unei protuberante continuta de rigola. Blocajul nu asigura fixarea gratarului pe rigola. Pentru obtinere unei prinderi stabile va sfatuim sa utilizati sistem de prindere cu bareta sau clip.

NOTA: Dimensiunile si greutatile se incadreaza in limite normale de toleranta.



# GRATARE

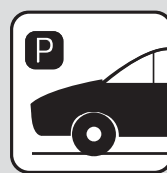

B 125

FLAT 100

## APLICATII ZINCAT

Trotuare  
Zone de stationare si parcuri private

## APLICATII INOX

Trotuare  
Zone de stationare si parcuri private  
Industria alimentara  
Mediu chimic agresiv

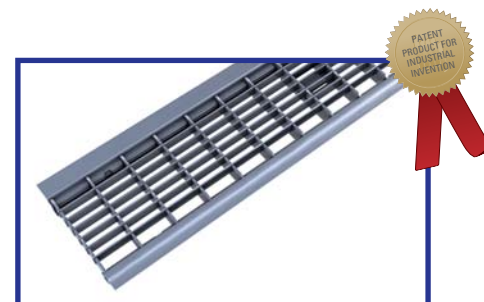
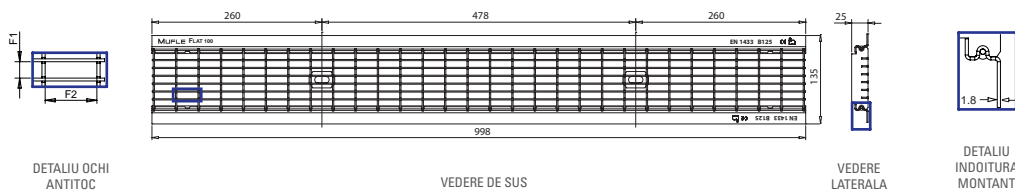

### GRATAR FAGURE ANTITOC



COD	PRET €	MATERIAL	DIMENSIUNI L x l x h mm	GREUTATE kg	SUPRAFATA DRENARE dm <sup>2</sup>	DESCHIDERE F1 x F2 mm	PRINDERE	
							bareta	zimt (fara fixare)***
506102		otel DD11 (1.0332)** zincat la cald	998 x 135 x 1,8	3,30	7,05	10,2 x 32,2		
506106		otel inox AISI 304* decapat						
506104		otel DD11 (1.0332)** zincat la cald	498 x 135 x 1,8	1,65	3,525			
506108		otel inox AISI 304* decapat						

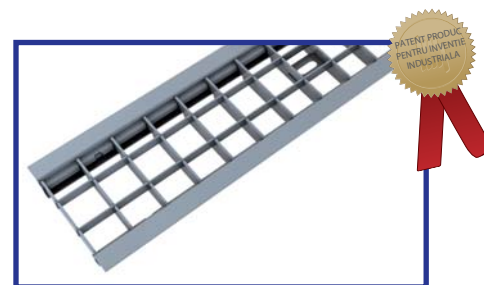
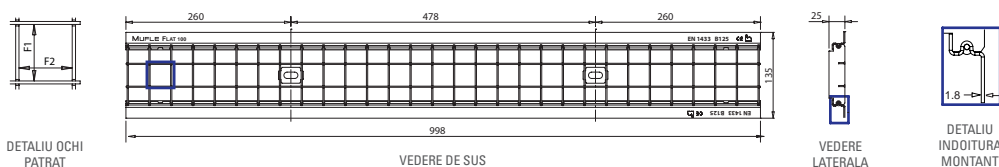

### GRATAR FAGURE



COD	PRET €	MATERIAL	DIMENSIUNI L x l x h mm	GREUTATE kg	SUPRAFATA DRENARE dm <sup>2</sup>	DESCHIDERE F1 x F2 mm	PRINDERE	
							bareta	zimt (fara fixare)***
506103		otel DD11 (1.0332)** zincat la cald	998 x 135 x 1,8	2,80	7,10	34,2 x 32,2		
506107		otel inox AISI 304* decapat						
506105		otel DD11 (1.0332)** zincat la cald	498 x 135 x 1,8	1,40	3,55			
506109		otel inox AISI 304* decapat						

\* Clasificare conform normei americane ASTM.

\*\* Clasificare conform normei EN 10111 (ed. martie 2000) si simbolistica conform normei EN 10027-1 (-2) (ed. septembrie 1993).

\*\*\* Sistem de blocare cu ajutorul unei protuberante continuta de rigola. Blocajul nu asigura fixarea gratarului pe rigola. Pentru obtinere unei prinderi stabile va sfatuim sa utilizati sistem de prindere cu bareta sau clip.

NOTA: Dimensiunile si greutatile se incadreaza in limite normale de toleranta.



# GRATARE



C 250

FLAT 100

## APLICATII FONTA

Coroane stradale  
Centre istorice (trafic lent)  
Zone de parcare  
Parcari multietajate

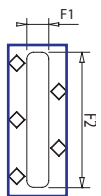

DETALIU FISURA

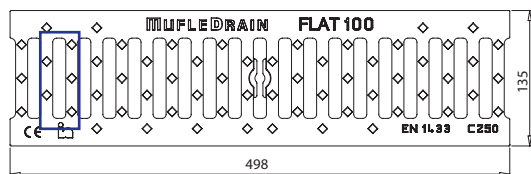

VEDERE DE SUS

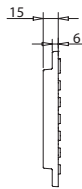

VEDERE LATERALA

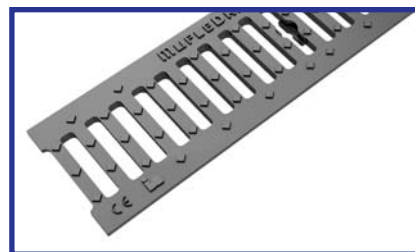

## GRATAR CU FANTA 13 mm



COD	PRET €	MATERIAL	DIMENSIUNI L x l x h mm	GREUTATE kg	SUPRAFATA DRENARE dm <sup>2</sup>	DESCHIDERE F1 x F2 mm	PRINDERE	
							bareta	fara fixare
506100		fonta nodulara GJS 500/7* vopsita cu vopsea apoasa	498 x 135 x 6	3,50	1,90	13,0 x 80,0		pana la clasa C250 conform normei EN 1433



DETALIU FISURA

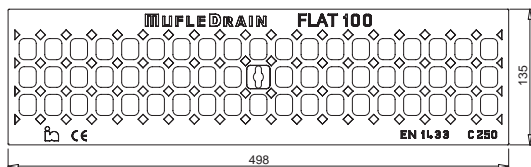

VEDERE DE SUS

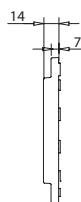

VEDERE LATERALA

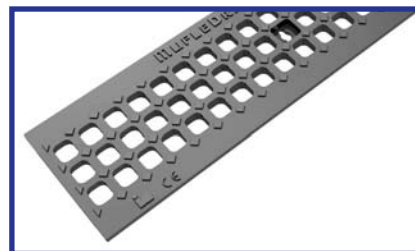

## GRATAR FAGURE



COD	PRET €	MATERIAL	DIMENSIUNI L x l x h mm	GREUTATE kg	SUPRAFATA DRENARE dm <sup>2</sup>	DESCHIDERE F1 x F2 mm	PRINDERE	
							bareta	fara fixare
506101		fonta nodulara GJS 500/7* vopsita cu vopsea apoasa	498 x 135 x 7	3,30	2,15	21,0 x 17,0		pana la clasa C250 conform normei EN 1433

\* Clasificare conform normei EN 1563 (ed.martie 2004).

NOTA: Dimensiunile si greutatile se incadreaza in limite normale de toleranta.



# ACCESORII

# FLAT 100

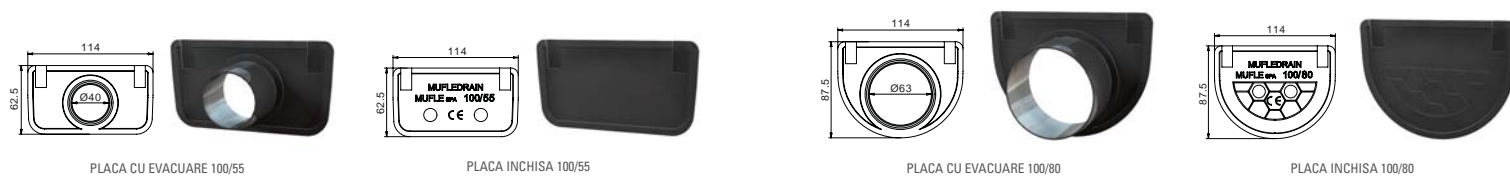

PLACA CU EVACUARE 100/55

PLACA INCHISA 100/55

PLACA CU EVACUARE 100/80

PLACA INCHISA 100/80

## PLACI DE CAPAT

COD	PRET	TIP	MATERIAL	UTILIZATE PENTRU RIGOLE	EVACUARI PREINSTALATE
	€				mm
700500		placa cu evacuare	PE-HD	100/55	1 x Ø 40
700508		placa inchisa	PE-HD	100/55	-
700501		placa cu evacuare	PE-HD	100/80	1 x Ø 63
700509		placa inchisa	PE-HD	100/80	-

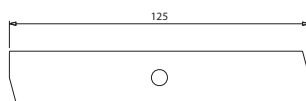

VEDERE DE SUS

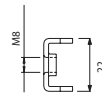

VEDERE LATERALA



## KIT BARETA + SURUBURI

COD	PRET	MATERIAL	UTILIZATA PENTRU GRATARE	SURUBURI	COMPOZITIE KIT PENTRU 1 ml
	€				
500412		otel zincat	FLAT otel zincat	M8 x 40 TBL combi	2 barete + 2 suruburi
500413		otel inox	FLAT otel inox	M8 x 40 TBL combi inox	2 barete + 2 suruburi
500414		otel zincat negru	FLAT fonta nodulara	M8 x 40 cap negru hexagonal	2 barete + 2 suruburi

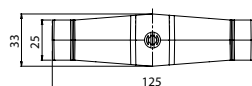

VEDERE DE SUS

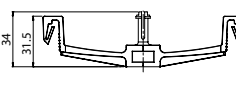

VEDERE LATERALA



## KIT CLIP

COD	PRET	MATERIAL	UTILIZAT PENTRU GRATARE	COMPOZITIE KIT PENTRU 1 ml
	€			
511212		PE-HD	100/55 - 100/80	2 clip

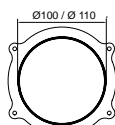

VEDERE DE SUS

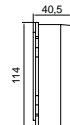

VEDERE LATERALA



## KIT RACORD DE EVACUARE + SURUBURI

COD	PRET	MATERIAL	UTILIZAT PENTRU RIGOLE	DIAMETRU	COMPOZITIE KIT PENTRU 1 ml
	€			mm	
506114		PE-HD	100/55 - 100/80	Ø 100	1 racord evacuare Ø 100 + 4 suruburi
506115		PE-HD	100/55 - 100/80	Ø 110	1 racord evacuare Ø 110 + 4 suruburi

NOTA: Dimensiunile si greutatele se incadreaza in limite normale de toleranta.



# PRODUSE SPECIALE

# FLAT 100

## COLTAR STANGA

## FLAT 100

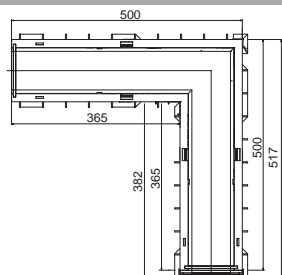

COD	PRET €	MODEL
706100		100/80
706101		100/55

## COLTAR DREAPTA

## FLAT 100

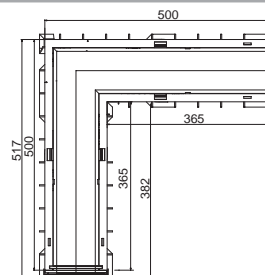

COD	PRET €	MODEL
706102		100/80
706103		100/55

## TEU STANGA

## FLAT 100

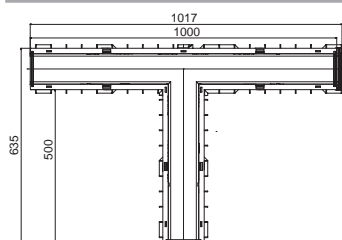

COD	PRET €	MODEL
706104		100/80
706105		100/55

## TEU DREAPTA

## FLAT 100

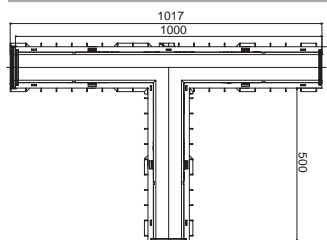

COD	PRET €	MODEL
706106		100/80
706107		100/55

## CRUCE

## FLAT 100

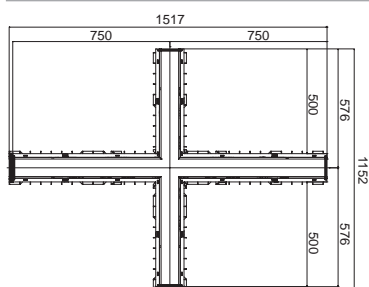

COD	PRET €	MODEL
706108		100/80
706109		100/55

NOTA: Dimensiunile si greutatele se incadreaza in limite normale de toleranta.